

A photograph of the Gravenhurst Public Library building, a two-story brick structure with a dark roof and a prominent gable window. The name "GRAVENHURST PUBLIC LIBRARY" is inscribed on the brick facade. A Canadian flag is visible on the left, and a lamp post is on the right. The scene is set during the day with some trees in the background.

GRAVENHURST PUBLIC LIBRARY

Summary Report of Gravenhurst  
Public Library Facility/Site Study  
Findings and Recommendations  
June 2018



**Gravenhurst Public Library Board**  
180 Sharpe St. West.  
Gravenhurst, Ontario P1P 1J1  
Canada

705-687-3382  
library@gravenhurst.ca

**Stephen Abram, MLS, FSLA**  
**Lighthouse Consulting, Inc.**  
120 Perth Ave., Suite 412  
Toronto, Ontario M6P 4E1

416-669-4855  
stephen.abram@gmail.com

**Brock James and Antero Fonte**  
**LGA Architectural Partners**  
533 College Street, Suite 301  
Toronto, Ontario M6G 1A8

416-203-7600  
lga-ap.com



# Key Findings

- Gravenhurst Public Library underperforms other library systems in the province. This is **not due to staff performance**, at all, but **due to a lack of facilities** which is driving these outcomes:
- GPL ranks in the bottom half overall of its peer libraries.
  - GPL ranks in the bottom half of its peers for cardholders, circulation, programs and technology per capita.
  - GPL ranks near the bottom of its peers for employees and expenditures per capita.
  - Low collection ownership per capita (and an inability to grow the collection due to space constrictions) based on full populations vs. permanent.

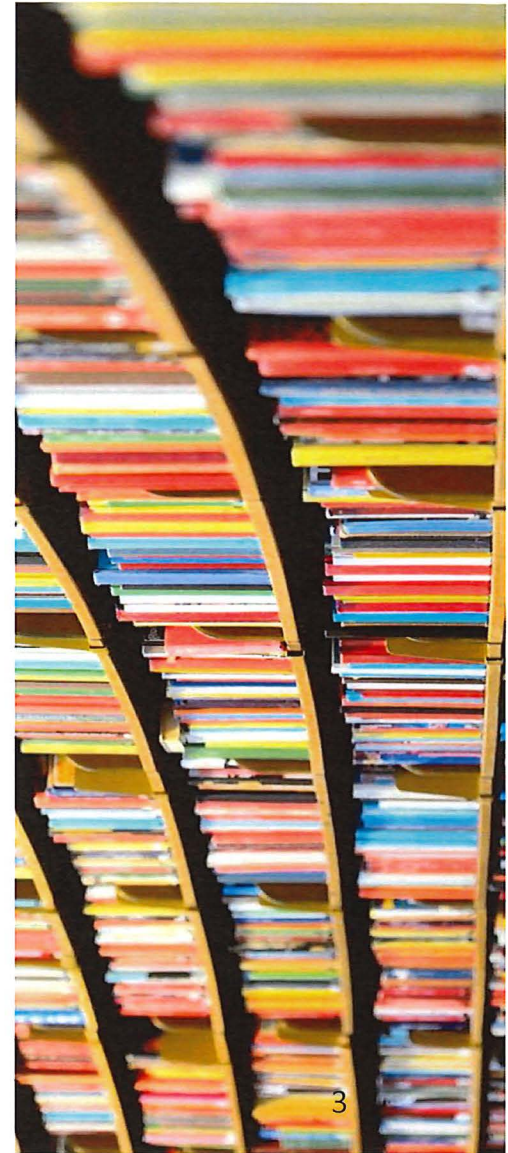

LIGHTHOUSE

LGA

architectural  
partners

# Risk Assessment

- The Town of Gravenhurst is under-resourced in the community building of the Public Library. GPL is operating very well in the context of this shortage of space, but the lack of space is driving low levels of cardholders, smaller collections size, and smaller than average program activities.
- GPL experiences crowding in many areas including the children's space, young adult area, multi-use program room, reading areas, public workstations, and staff work space etc.
- The summer – winter population and visitor dynamic is a special issue.
- The library's size and configuration of space has an impact on economic and social development, desirability as a place to move for employment, student success, employment success, addressing social needs including isolation, and more.

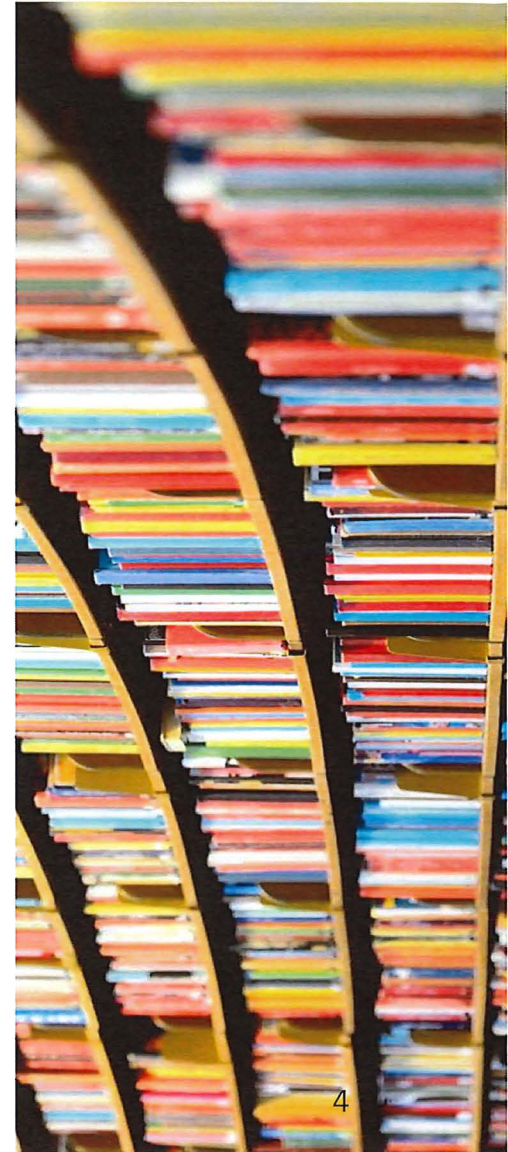

LIGHTHOUSE

LGA

architectural  
partners



# Executive Summary

- Gravenhurst Public Library is at a critical juncture.
- This study summarizes the facility-driven underperformance of the system and the requirement for a better and larger facility to meet expressed community needs.
- This study shows the recommended addition and renovations that will bring Gravenhurst up to provincial standards as well as a plan for a digital presence that will meet the community expectations through 2041.
- There are 7 recommendations to be considered.



LIGHTHOUSE

LGA

architectural  
partners

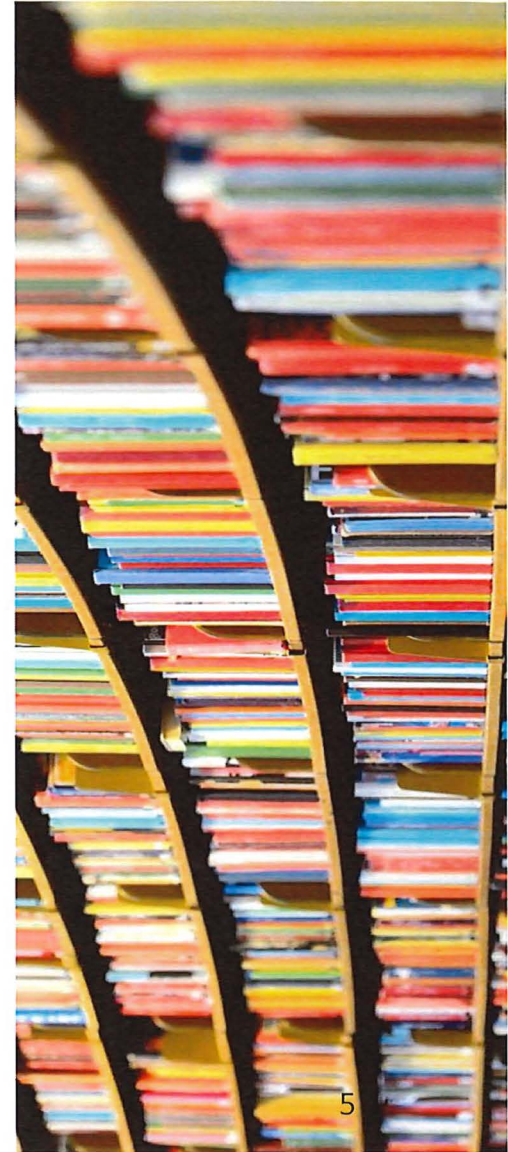

# Gravenhurst Recommendations Summary

1. Invest in an addition to the Library
2. Update and modernize the program strategy at the library
3. Successfully achieve provincial accreditation
4. Continue to build stronger ties to Gravenhurst Archives and local history
5. Ensure that the total population demographics are served
6. Invest in a digital presence and digital strategies
7. Build more effective staff work spaces

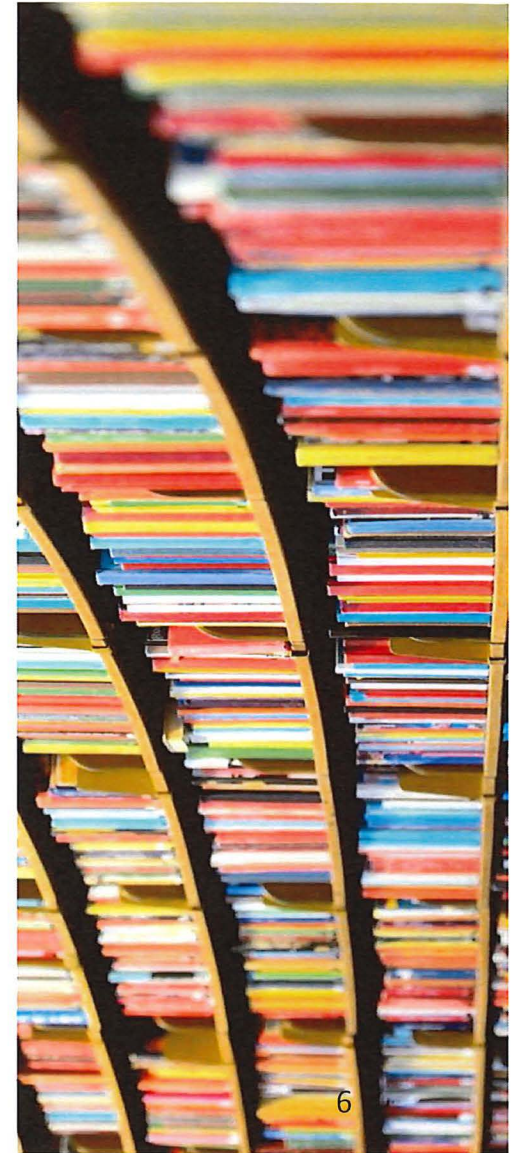



# Gravenhurst Public Library Recommendation 1: Invest in an addition to the Library

- Enlarging the Library will create space for residents of all demographics that will:
  - create a program hub with space for collections and computer and peripheral access.
  - have appropriate dedicated space for archives, children and teens, seniors, digital activities, connecting with neighbours, and so much more.
- Building on the high number of library visits to the downtown with partnerships and strategies can exploit these cardholders' visits.
- Expanding the social and economic impact beyond the public library to businesses, cultural institutions and events, and other downtown activities.



LIGHTHOUSE

LGA

architectural  
partners

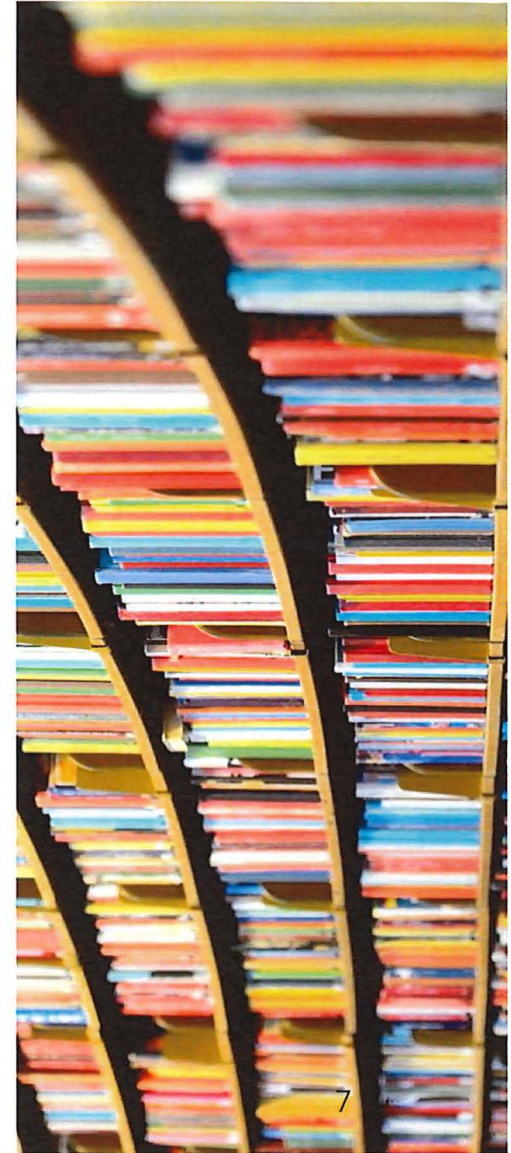

## Gravenhurst Public Library Recommendation 1: Invest in an addition to the Library

- The Library will be seen as a community hub where town and region-wide engagement activities can be housed and marketed.
- Gravenhurst Public Library attracts thousands of visits by residents, cottagers, and tourists to the Gravenhurst core. Building on this anchor institution would be a great way to generate traffic in addition to improving quality of life and property values in the core.

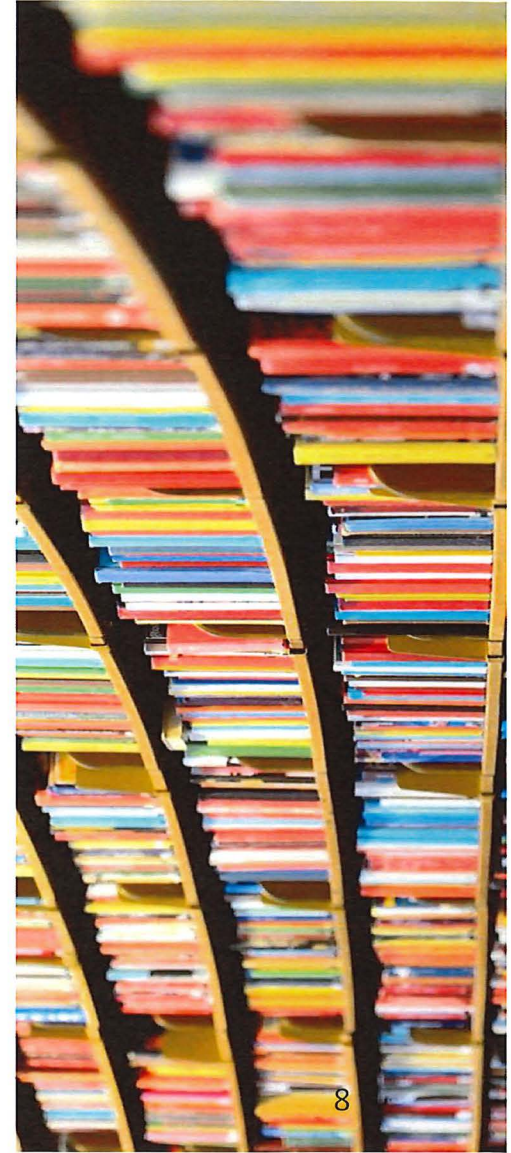

LIGHTHOUSE

LGA

architectural  
partners



# Gravenhurst Public Library Recommendation 1

## Invest in an addition to the Library

- Meet AODA (Accessibility for Ontarians with Disabilities Act) standards – especially the lift.
- Improving the entrance to make it more welcoming, to increase the efficiency of the space, and to upgrade security.

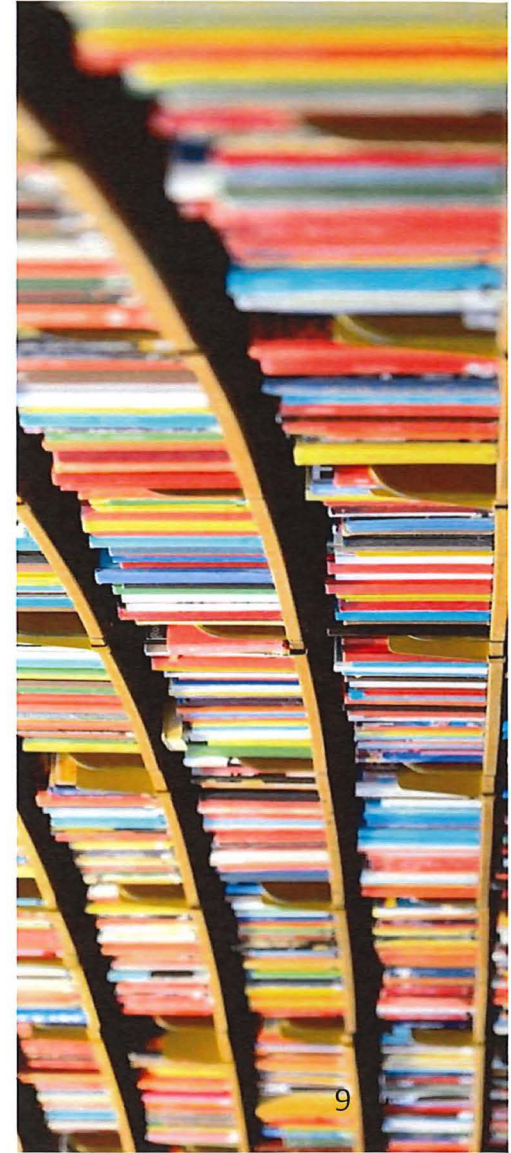

LIGHTHOUSE

LGA

architectural  
partners

# Gravenhurst Public Library Recommendation 2: Update and modernize the program strategy

## The physical interior space

- Reconstruct a space that is responsive to the needs of children, teens and adults
- Support programming elements with good spaces
- Create a community living room for neighbours to connect
- Enhance and enlarge Archives and local history space

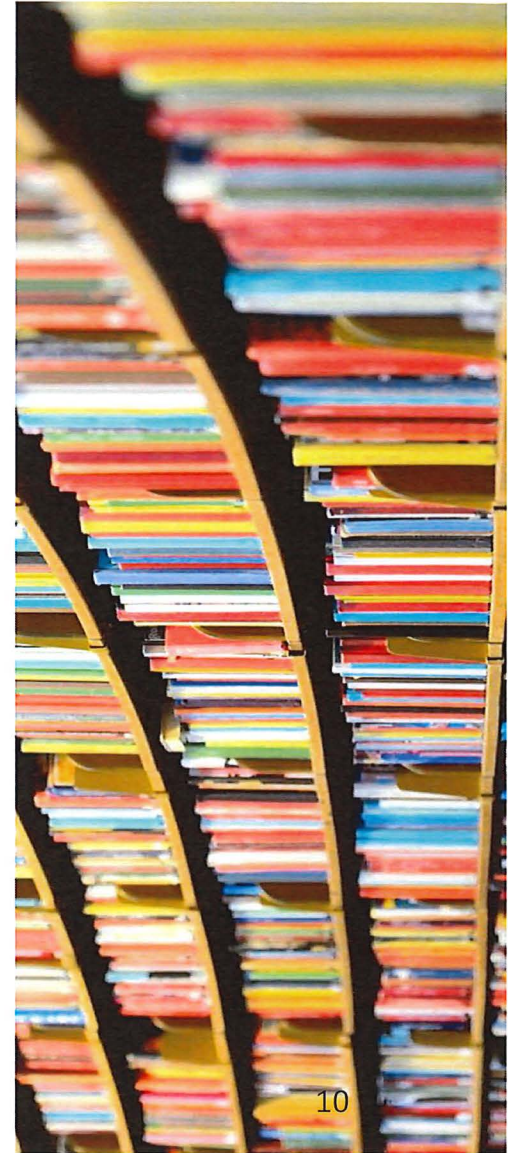



## Gravenhurst Public Library Recommendation 2: Update and modernize the program strategy

### Respond to low collection size

- Increase the size of the collection to meet community demand by implementing a collection development plan that targets growth of the collection in the context of supporting programming and the needs of the community.

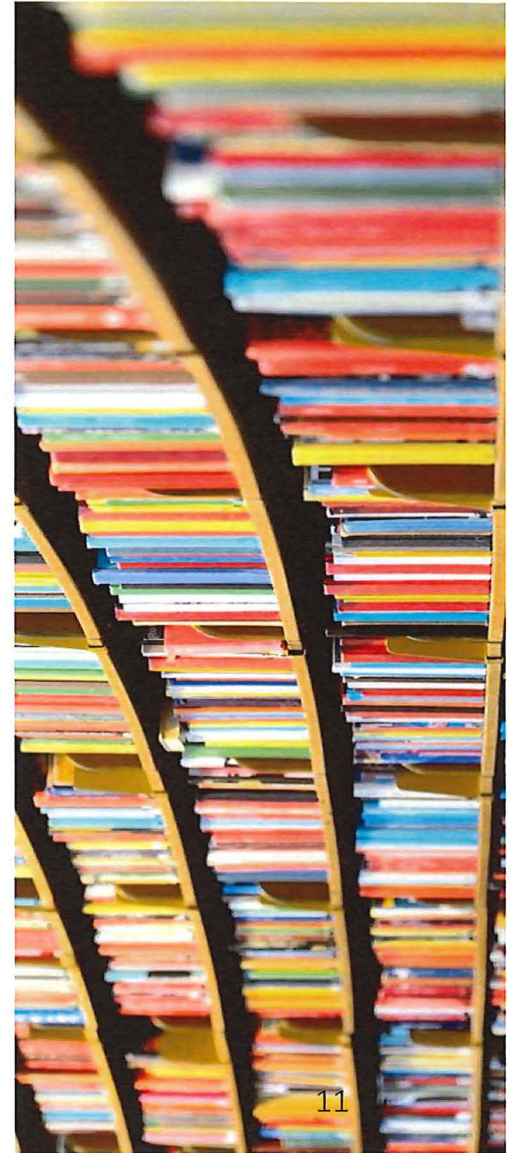

# Gravenhurst Public Library Recommendation 3: Successfully achieve provincial accreditation

## **Achieve provincial accreditation in 2019**

- Respond to the internal SOLS (Southern Ontario Library Service) audit.
- It is expected that future provincial funding opportunities may be dependent on accreditation.

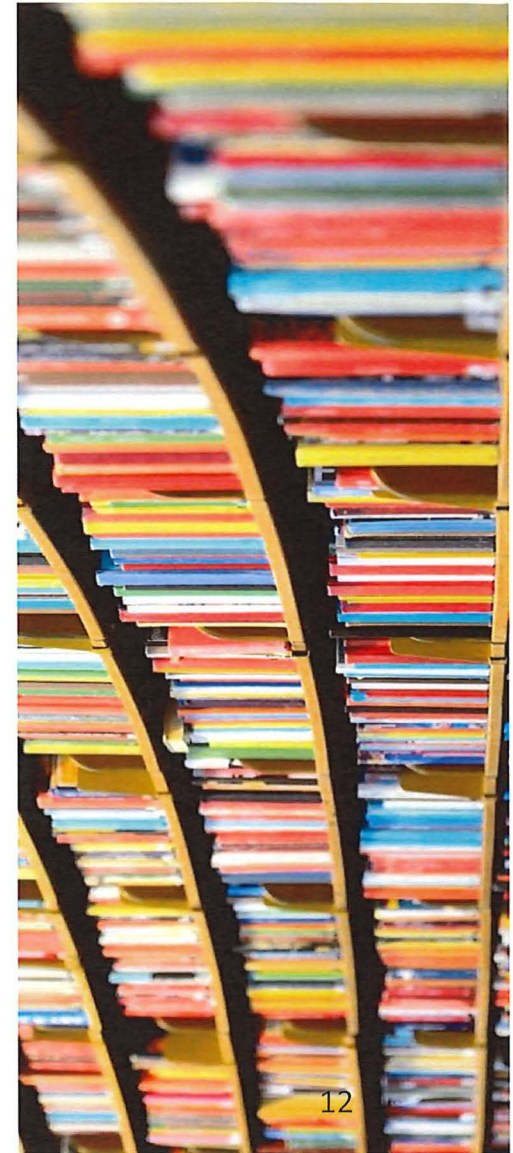



## Gravenhurst Public Library Recommendation 4: Build stronger ties to local history and Archives

- Repatriate and centralize the Archives into one location, as resources are currently at risk due to insufficient storage space.
- Build a local history room that provides increased workspace for the Archives volunteers to continue descriptive work and digitization projects.
- Use the local history room to promote Muskoka and Gravenhurst to the general public.

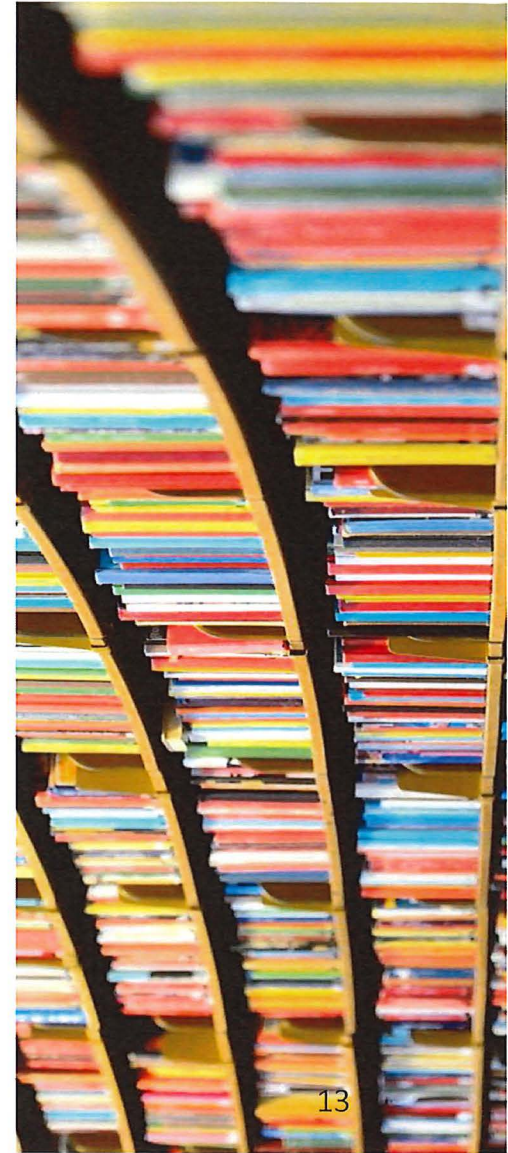

LIGHTHOUSE

LGA

architectural  
partners

## Gravenhurst Public Library Recommendation 5: Ensure service to all demographics

- Create dedicated spaces that meet the needs of our diverse demographic because current space is limited and has multiple, conflicting and overlapping uses.

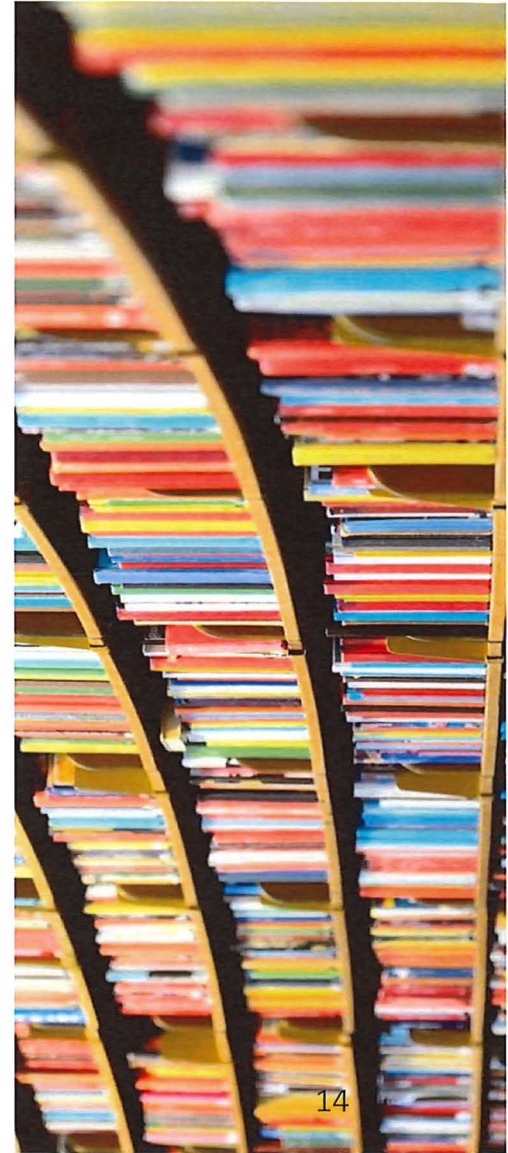



## Gravenhurst Public Library Recommendation 6: Invest in the Digital Presence and Digital Strategies

- Ensure that the digital presence of Gravenhurst Public Library brings people into the Library and stands as its own entity for marketing and promotion.
- This digital presence will provide content related to programming and services, encouraging people to come to the library.

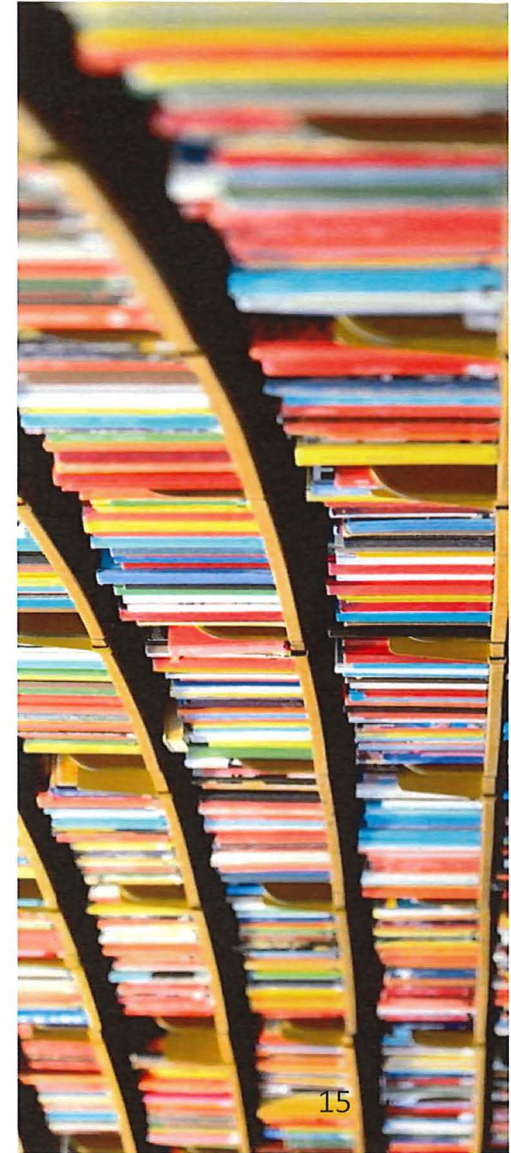

## Gravenhurst Public Library Recommendation 7: Build more effective staff work spaces

- Update the staff workroom with proper systems, furniture, equipment and storage to optimize for efficiency, effectiveness and collaboration.

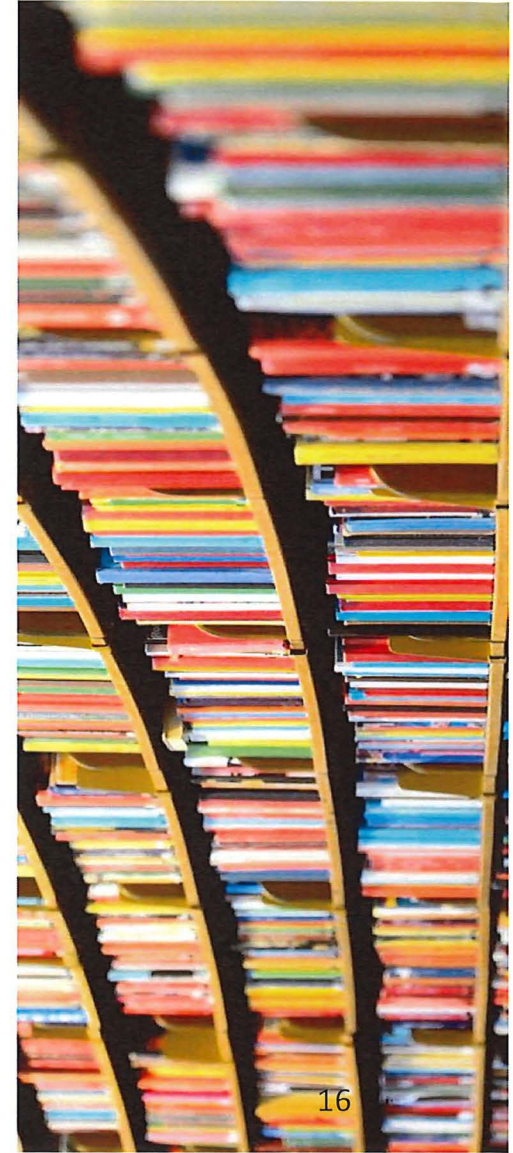



## Costing breakdown

Addition of 8,900 sq ft for a total of 16,899 sq ft

• Site Development	\$ 287,000	(1.)
• Two-storey Library Addition	\$ 3,718,000	(2.)
• Two-storey Library Renovation	\$ 3,125,000	(3.)
<b>• TOTAL CONSTRUCTION COST</b>	<b>\$ 7,130,000</b>	
• Outdoor reading area	\$ 68,450	(4.)

(1.) Excluding Outdoor Reading area

(2.) Incl. one-storey SE addition @ 2<sup>nd</sup> floor

(3.) Incl. demolitions and structural reinforcements

(4.) As a separate price (not included in overall contract price)



# Gravenhurst Public Library Map

An  
Ideal  
Community  
Hub

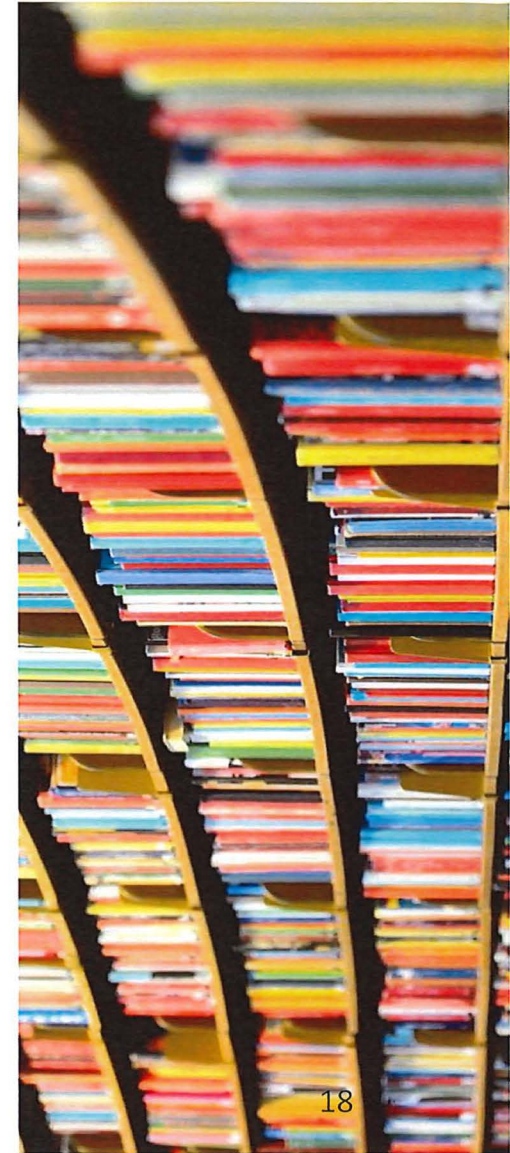
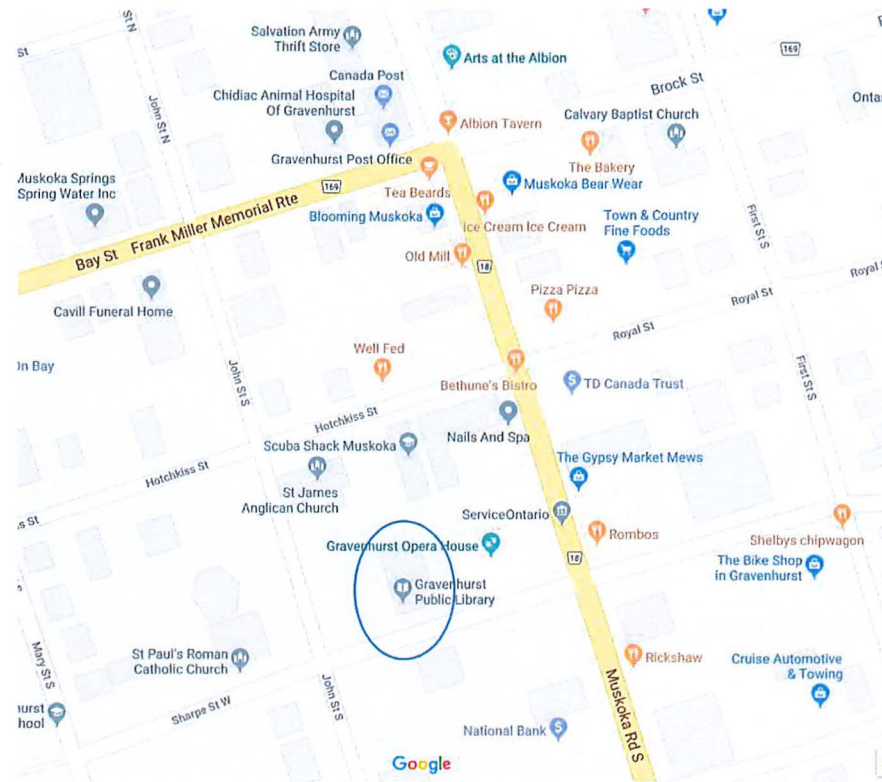



# Gravenhurst Site

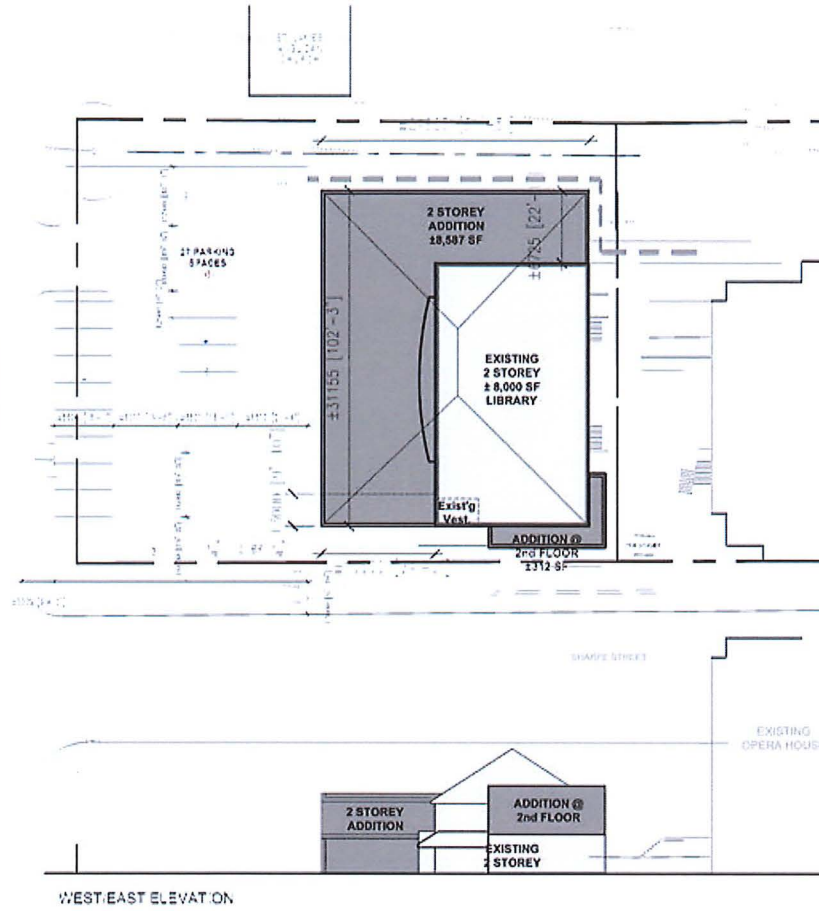
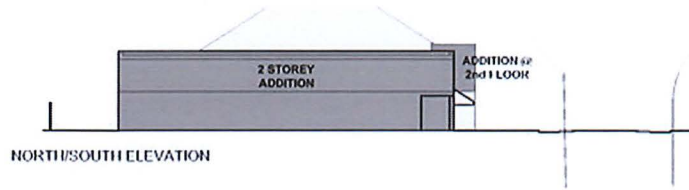

Site Plan



# Bubble Diagram 1<sup>st</sup> Floor

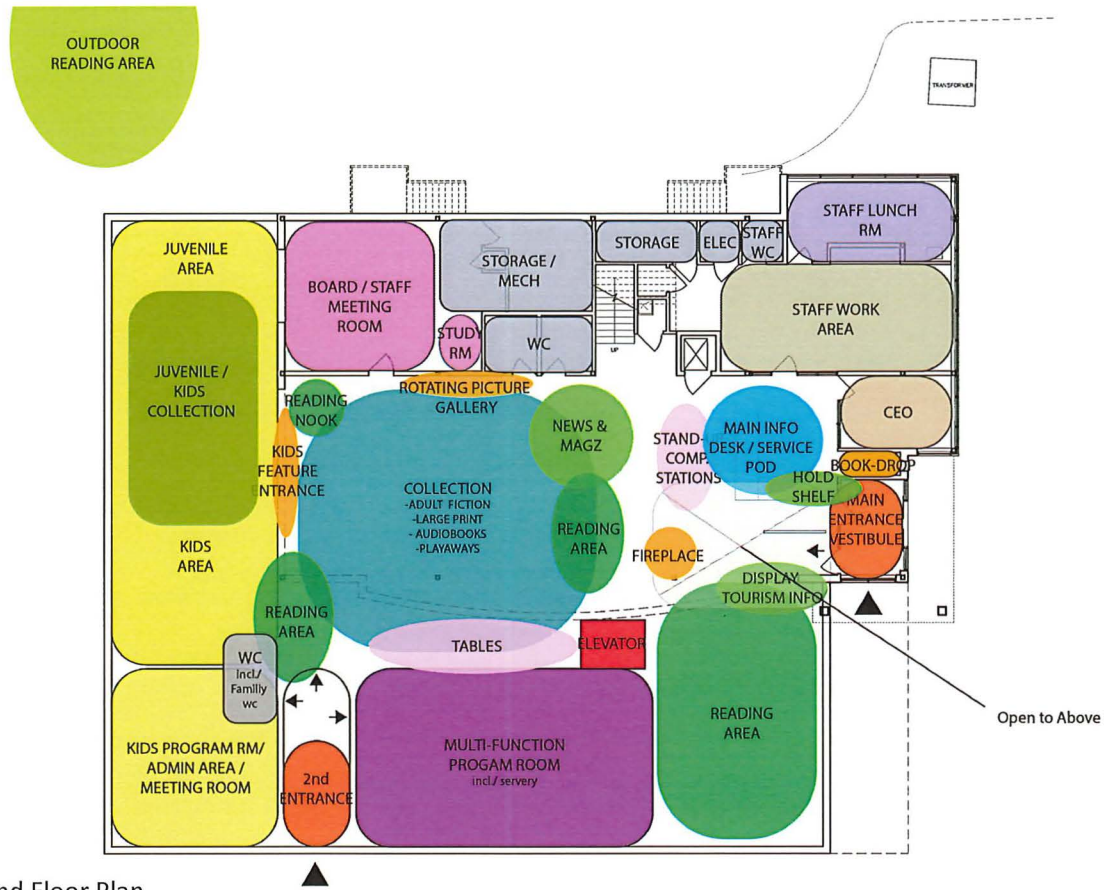

Ground Floor Plan





# Bubble Diagram 2<sup>nd</sup> Floor

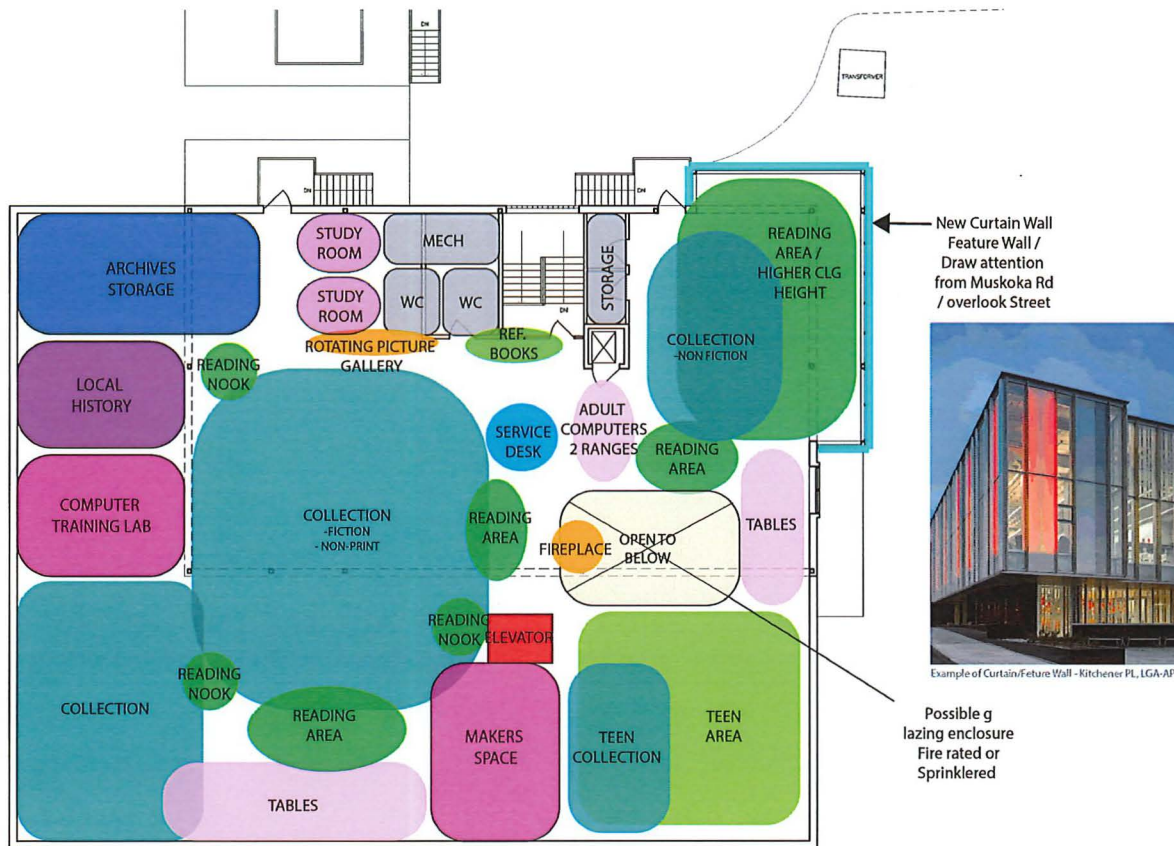

Second Floor Plan



# Major Conclusion

- With Gravenhurst's permanent population projected to reach 17,300 by 2041 and seasonal population projected to reach 13,600 by 2041, the currently under-sized space will truly be stressed to meet its commitments to the community.
- As seasonal regional strategies become more 4-season, and residents of southern Ontario choose to retire in Gravenhurst, greater pressure will be placed on the library's space.
- Combined with the currently inflexible, insufficient program spaces and the need for more space for collections, the library needs a renovation and addition to its 2-storey footprint as recommended.

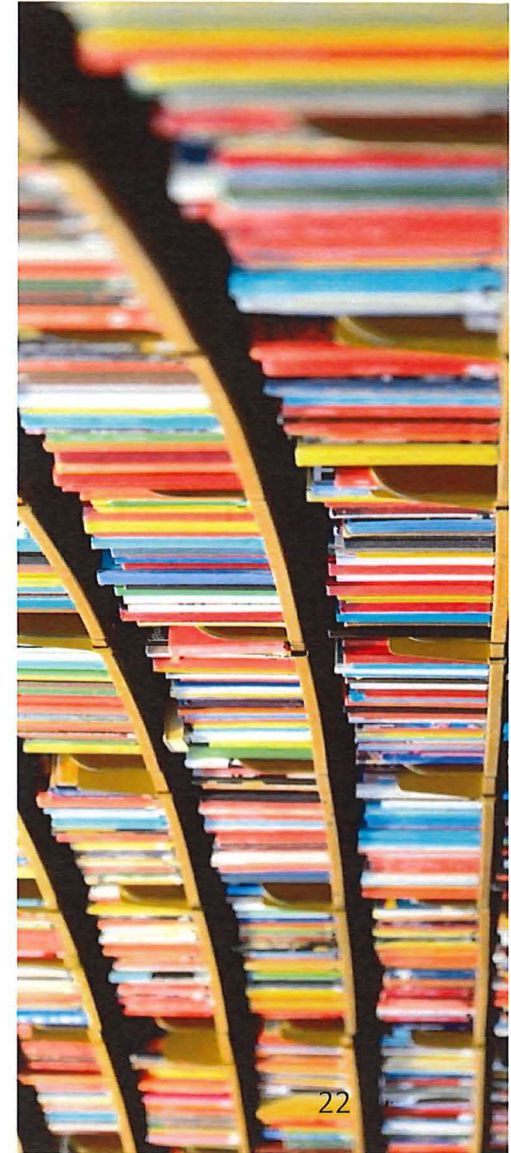



Thanks very much!

Comments/Questions?



LIGHTHOUSE

**LGA**

architectural  
partners

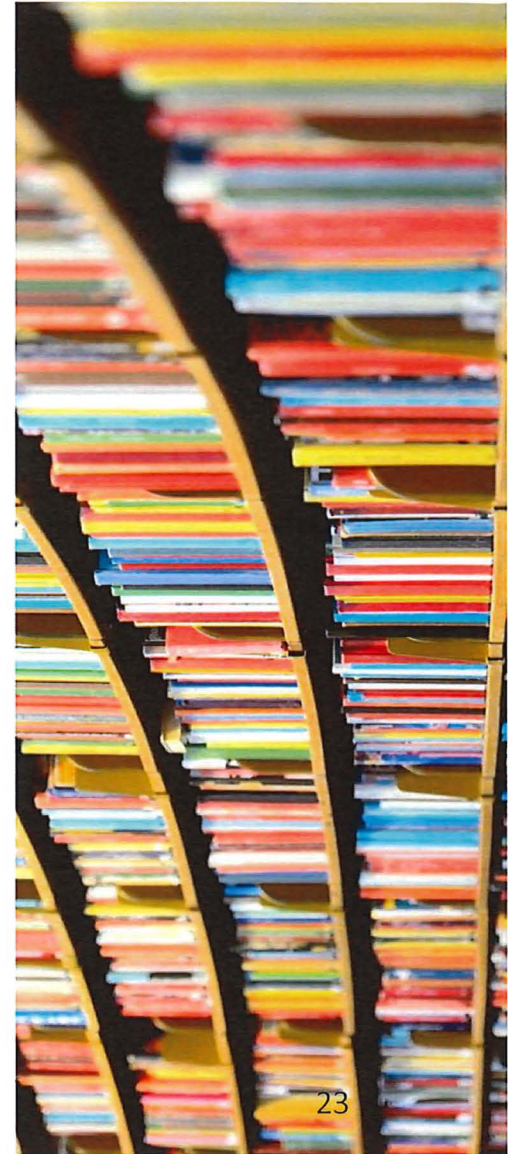



**Gravenhurst Public Library Board**  
180 Sharpe St. West.  
Gravenhurst, Ontario P1P 1J1  
Canada

705-687-3382  
library@gravenhurst.ca



**Stephen Abram, MLS, FSLA**  
**Lighthouse Consulting, Inc.**  
120 Perth Ave., Suite 412  
Toronto, Ontario M6P 4E1

416-669-4855  
stephen.abram@gmail.com



**Brock James and Antero Fonte**  
**LGA Architectural Partners**  
533 College Street, Suite 301  
Toronto, Ontario M6G 1A8

416-203-7600  
lga-ap.com